

DRAWING NOTES

NOTES

It is the responsibility of the appropriate contractor to check and verify all dimensions on site and report all errors and or omissions to the Architect.

All contractors must comply with all pertinent codes and by-laws.

Do not scale drawings.

This drawing may not be used for construction until signed by the Architect.

Copyright reserved.

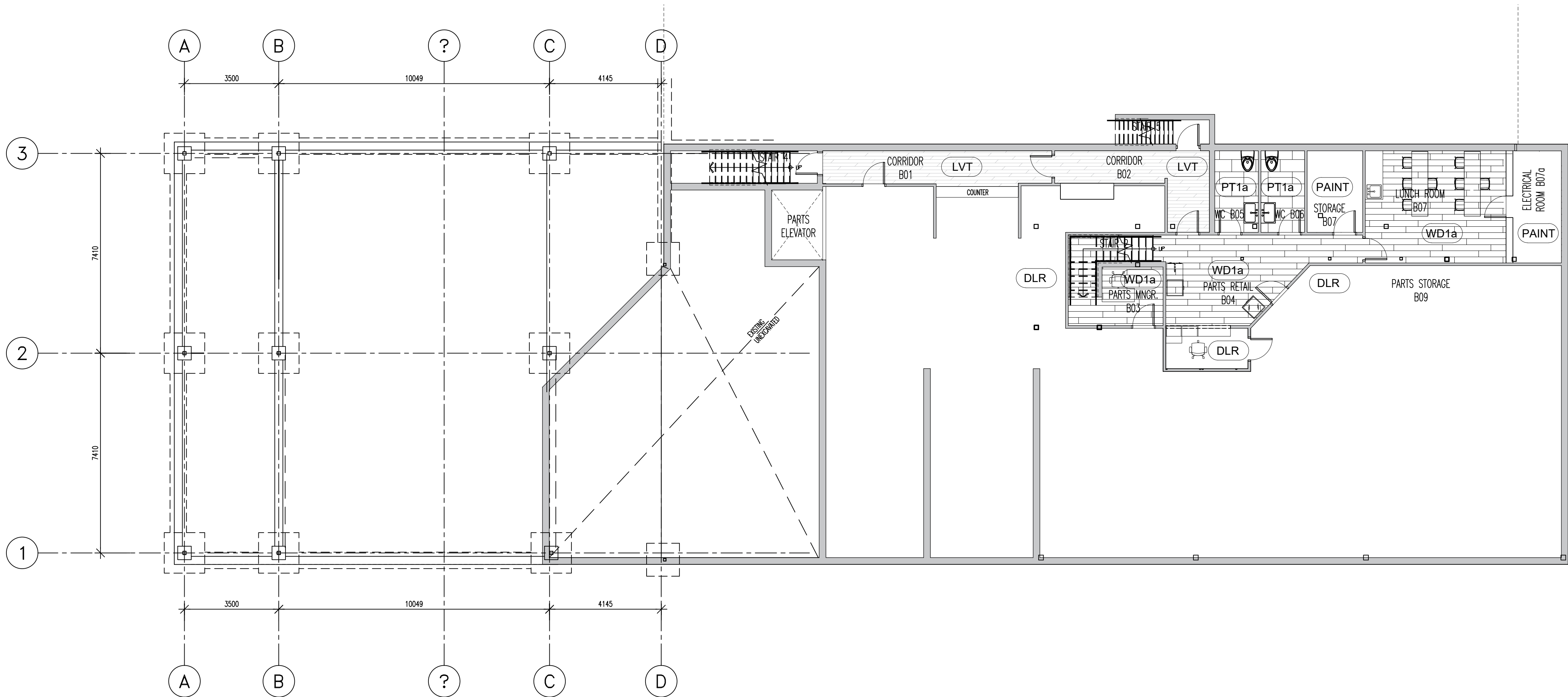
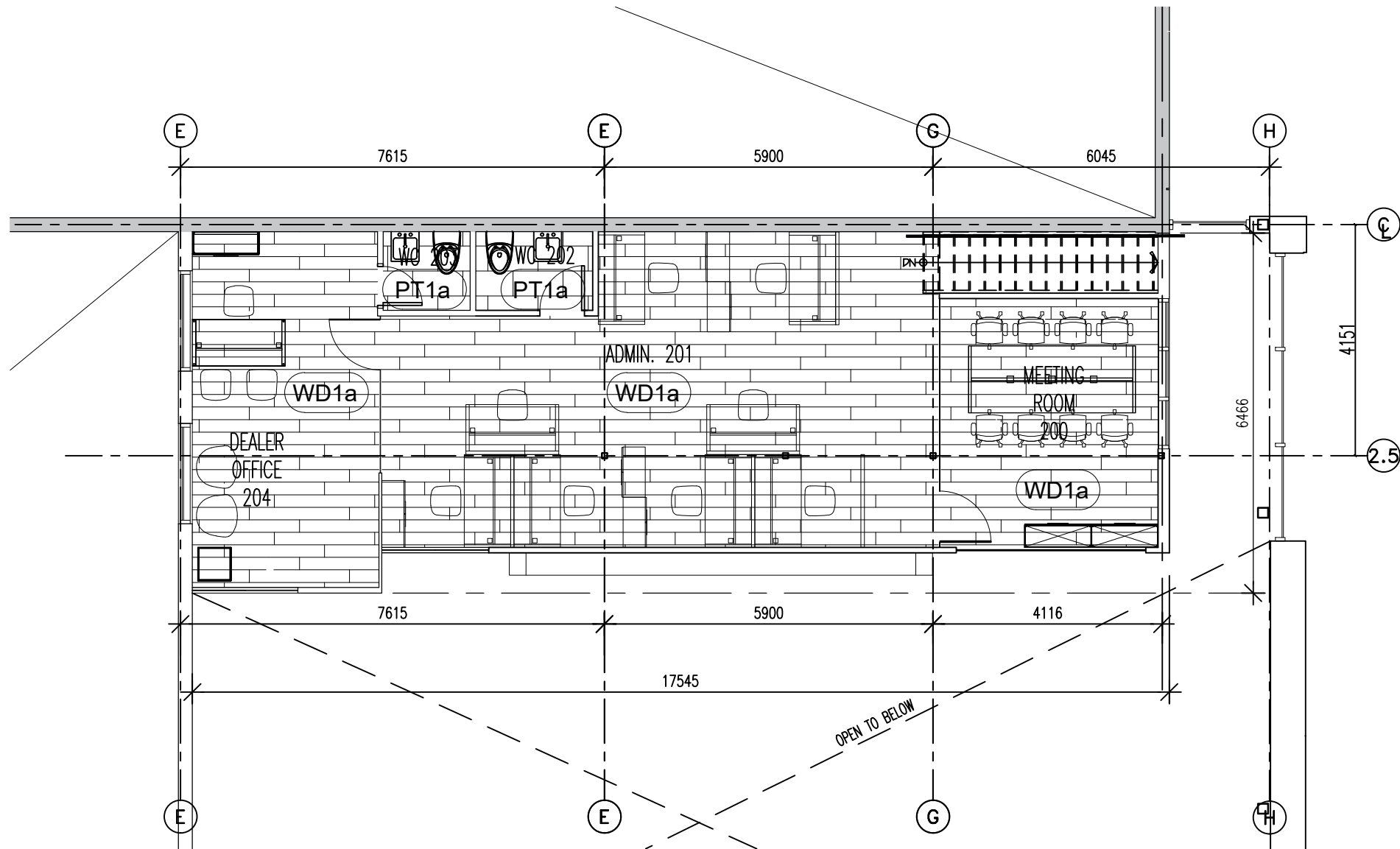

LEGEND

- PT1** PORCELAIN TILE, SEE VV FINISHES SPECIFICATION 60 x 60cm (24 x 24") RUNNING BOND PATTERN.
- PT1a** PORCELAIN TILE, SEE VV FINISHES SPECIFICATION 30 x 30cm (12 x 12") or 20 X 20cm (8X8") RUNNING BOND PATTERN.
- PT2** PORCELAIN TILE, SEE VV FINISHES SPECIFICATION FINISH 30 x 30cm (12 X 12") RUNNING BOND PATTERN.
- PT3** PORCELAIN TILE, SEE VV FINISHES SPECIFICATION FINISH 20 x 20cm (8x8") or 30 x 30cm (12 X 12")
- PT4** PORCELAIN TILE, SEE VV FINISHES SPECIFICATION 20 X 20cm (8X8").
- WD1a** EMIL CERAMICA HAVANA CHERRY TILE 20 X 120cm
- CP1** TINTED SEALED CONCRETE
- FM1** PEDIMAT
- DLR** FLOORING TO BE DETERMINED BY DEALER
- CA** TANDUS CENTIVA CARPET
- CLT1** CONCRETE-LOOK TILES, SEE VV FINISHES SPECIFICATION FINISH 60 x 60cm (24x24")
- LVT** PATCH CONCRETE SLAB. INSTALL NEW H/D LVT
- PAINT** PATCH CONCRETE SLAB. PAINT FLOOR. COLOUR BY OWNER
- NOTE:**  
1) THIS LEGEND IS TO BE READ IN CONJUNCTION WITH DCD FINISH

NO	DATE	REVISION	STAMP
1	18 OCT '24	ISSUED FOR TENDER	

**brian k. clark**  
**A·R·C·H·I·T·E·C·T**  
141 Catherine Street, Unit 102  
Ottawa, Ontario K2P 1C3  
TEL: (613) 238-7412 • FAX: 238-1799  
Email bkclarkarchitect@gmail.com

PROJECT  
**BYTEK VW RENOVATION**  
**1325 ST. LAURENT BLVD.**

OTTAWA ONTARIO  
DRAWING  
**MEZZANINE AND BASEMENT FLOOR FINISHES PLANS**

PROJECT NO.	DRAWN BY:	SCALE:
2301	DP	1:100

DATE:	DRAWING NO.
OCT. 2023	<b>A-505</b> Rv1

NORTH ARROW: